

22MM PLASTIC ROUND COMPLETE UNIT
COMBINATION: PUSHBUTTON WITH FLAT BUTTON
SCREW TERMINAL,
1NO WITH HOLDER BLACK

Actuator:

Design of the product	Complete unit round
Design of the operating mechanism	Pushbutton
Functionality / of the actuator	Momentary contact type
Type of unlocking device	without
Color / of the activation element	black
Material / of the activation element	plastic
Shape / of the activation element	Flat pushbutton
Number of switching positions	2
Product component / front ring	Yes
Material / of the front ring	plastic
Color / of the front ring	black
Design of the front ring	Standard
Product function / EMERGENCY STOP function	No

Holder:

Material / of the holder	Plastic
--------------------------	---------

Contact block/ lampholder:

Design of the electrical connection	screw-type terminals
Number of switching elements	1

Number of NC contacts / for auxiliary contacts		0
Number of NO contacts / for auxiliary contacts		1
Number of changeover contacts / for auxiliary contacts		0
Product function / positive opening		No
Number of lampholders		0
Product component / fluorescent materials		No
Product extension / optional / fluorescent materials		No

Accessories:

Product component / holder for 3 switching elements

No

General technical data:

Voltage type / of operating voltage

AC/DC

Operating voltage / rated value

- minimum
- maximum

V
V

5
400

Operating current

- at AC-12
 - at 24 V / rated value
 - at 48 V / rated value
 - at 110 V / rated value
 - at 230 V / rated value
 - at 400 V / rated value
- at AC-15
 - at 24 V / rated value
 - at 48 V / rated value
 - at 110 V / rated value
 - at 230 V / rated value
 - at 400 V / rated value
- at DC-12
 - at 24 V / rated value
 - at 48 V / rated value
 - at 110 V / rated value
 - at 230 V / rated value
- at DC-13
 - at 24 V / rated value
 - at 48 V / rated value
 - at 110 V / rated value
 - at 230 V / rated value

A
A
A
A
A

A
A
A
A
A

A
A
A
A

A
A
A
A

10
10
10
10
10

6
6
6
6
3

10
5
2.5
1

3
1.5
0.7
0.3

Resistance against shock

• for devices without incandescent lamp / according to IEC 60068-2-27		<= 50g
Resistance against vibration / according to IEC 60068-2-6		20 ... 200 Hz: 5g
Operating cycles / maximum	1/h	1,000
Mechanical operating cycles as operating time / typical		10,000,000
Reference code • according to DIN EN 61346-2 • according to DIN 40719 extended according to IEC 204-2 / according to IEC 750		S S
Tightening torque / of the screws in the bracket / maximum	N·m	1
Ambient temperature • during operating • during storage	°C °C	-25 ... +70 -40 ... +80
Protection class IP		IP66
climatic class / during the operating phase / according to EN 60721		3K6
Mounting type		front mounting
Shape / of the installation hole		round
Installation width	mm	28.5
Mounting diameter	mm	22
Mounting height	mm	8
Mounting depth	mm	49

Certificates/ approvals:

General Product Approval



[Special Test Certificate](#)

Shipping Approval



other

[Confirmation](#)

[other](#)

[Environmental Confirmations](#)

Further information:

Information- and Downloadcenter (Catalogs, Brochures,...)

<http://www.siemens.com/industrial-controls/catalogs>

Industry Mall (Online ordering system)

<http://www.siemens.com/industrial-controls/mall>

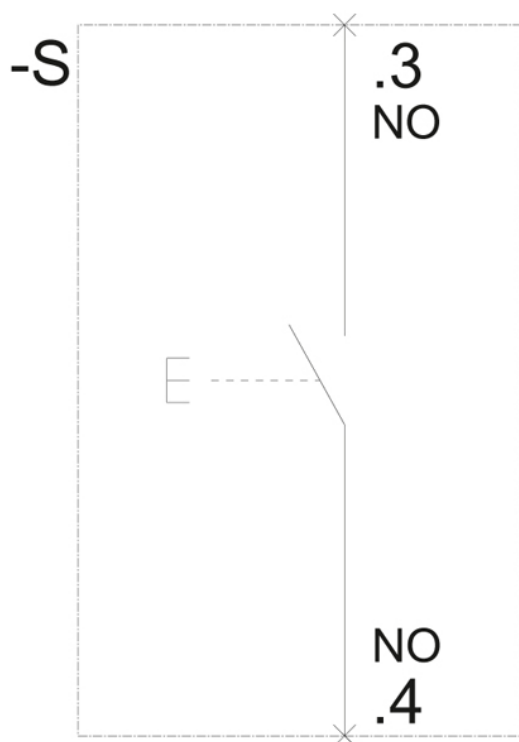
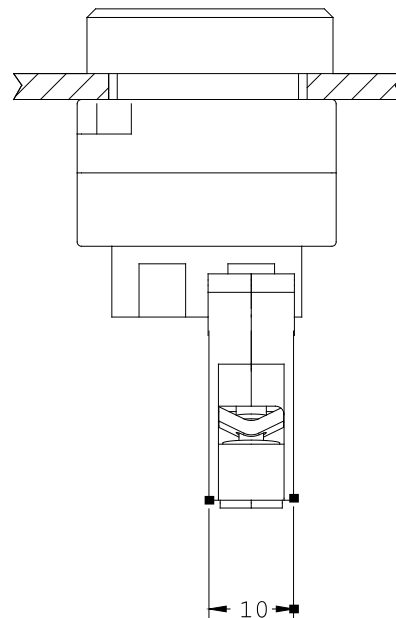
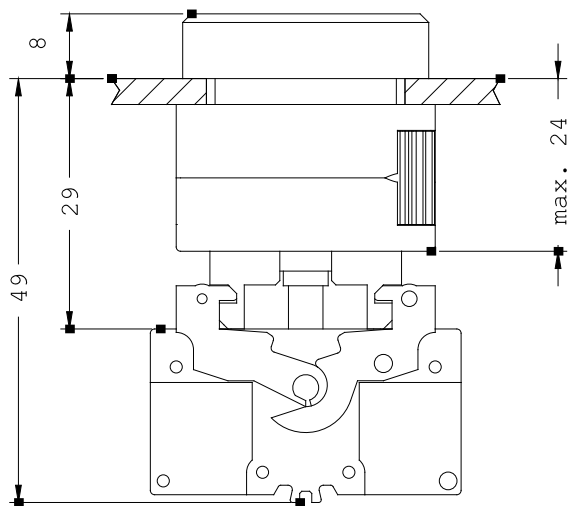

last change:

Jul 7, 2014