

Bluetooth GPS Receiver

User's Guide

Jun. 12, 2004 V 1.0





After acquiring your Bluetooth GPS Receiver, proceed with the following steps:

1. Install battery. Fully charge battery for at least eight hours before first use.

Battery low	When LED 1 flashes green light, it signals battery low. Connect Bluetooth GPS Receiver to a power source for continue operation and recharge simultaneously.
Charging	When battery is being charged, LED 1 turns to orange light; When the battery has been fully charged, LED 1 turns to green light.

2. Turn on Bluetooth GPS Receiver

Press the power button for 2 second or until LED1 turns into red and green shifting light, and the LED 2 turns to blue flashing light. This is to activate Bluetooth pairing, it's required only once at first use.

3. Activate Bluetooth function of your PDA / PC

Prior to activating the Bluetooth function of your PDA / PC, make sure the device is equipped with Bluetooth function, and the driver software has been installed.

4. Activate Bluetooth Manager & Established New Connections

Illustrations using HP 2100 PDA as follows:

1. First, find the device with which you wish to establish connection.
2. Open “Bluetooth Manager” on your pocket pc.
3. Press “New”.
4. Press "Connect”.



圖 4.1



圖 4.2

Before going to next step, press Bluetooth GPS key for 4 seconds until LED 2 starting to flash, signaling the connecting is in progress.



圖 4.3



圖 4.4

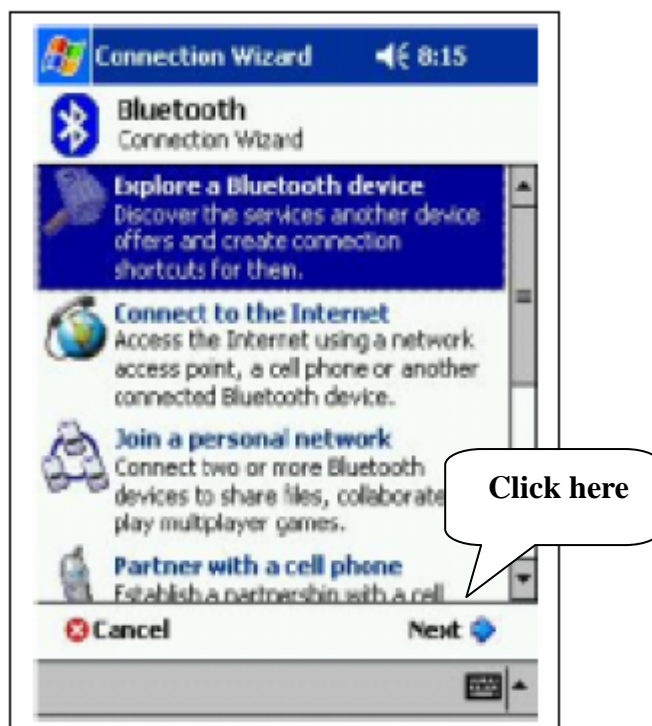

圖 4.5



圖 4.5

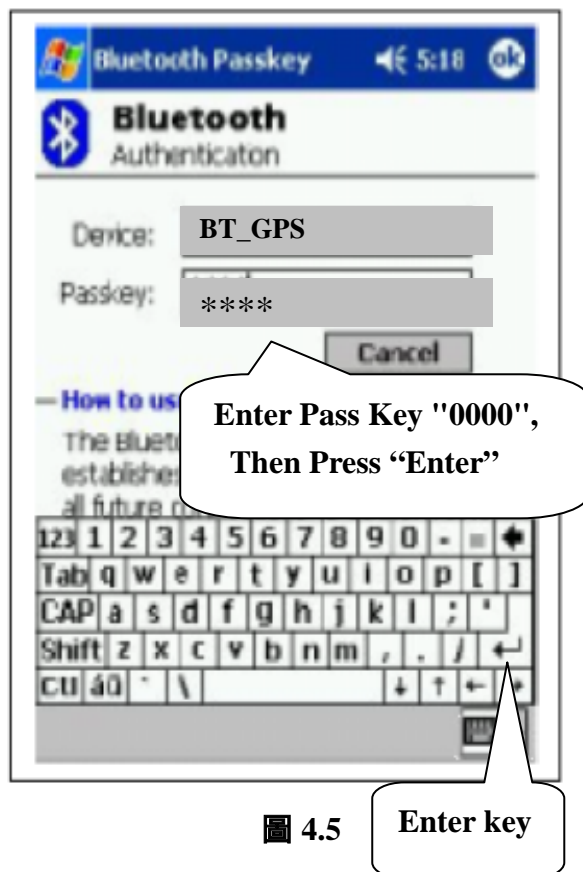

圖 4.6

At this point, Bluetooth GPS connection has been successfully established

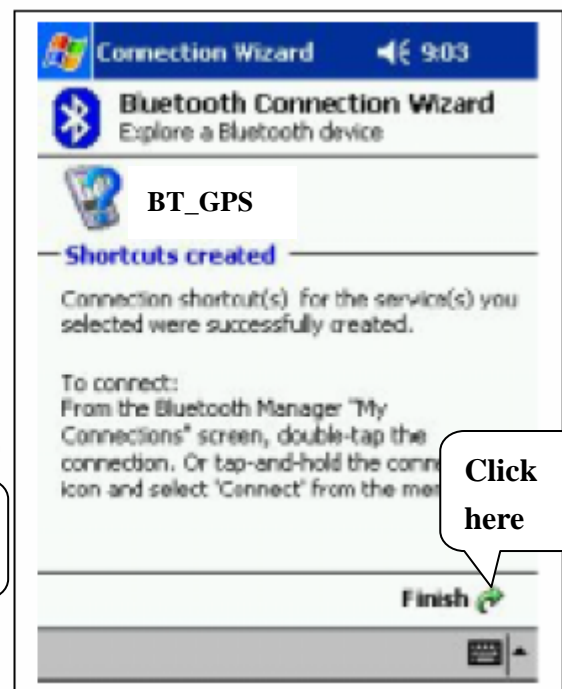

圖 4.7

When LED 2 flashes, it's indicating Bluetooth GPS and the electronic map connection is in progress.

6. Turn off Bluetooth GPS Receiver

Press power button for 2 second or until LED1 indicator flashing red and green lights simultaneously. At the point, power will be automatically shut off.

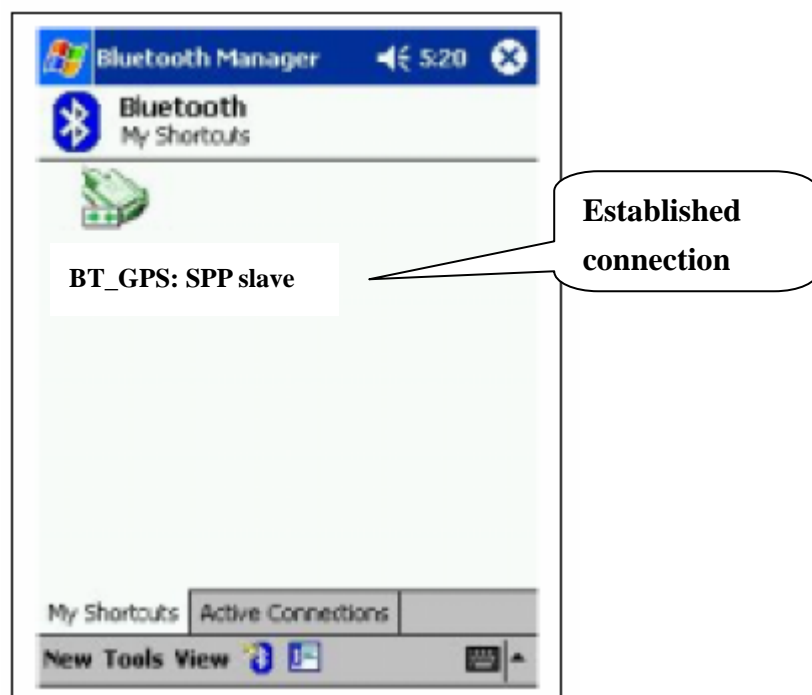
Suggest electronic map be turned off before GPS, to avoid possible PDA /PC freeze.

7. About signals

- LED1 :**
- a. Red light indicates GPS tracking function has been activated.
 - b. Orange light indicates Bluetooth GPS Receiver is being charged.
 - c. Green light, while flashing, indicates battery low, steady light indicates fully charged battery.
- LED2 :**
- a. Blue light, flashing swiftly signals pairing, flashing once a second signals PDA/PC and Bluetooth GPS Receiver has been connected; flashing every 3 seconds signals connection failed.

Note!! Bluetooth GPS Receiver is compatible with ASUS-620, Compaq 2210, PH, Palm.