

## Shape and size : ( Dimensions are in mm )

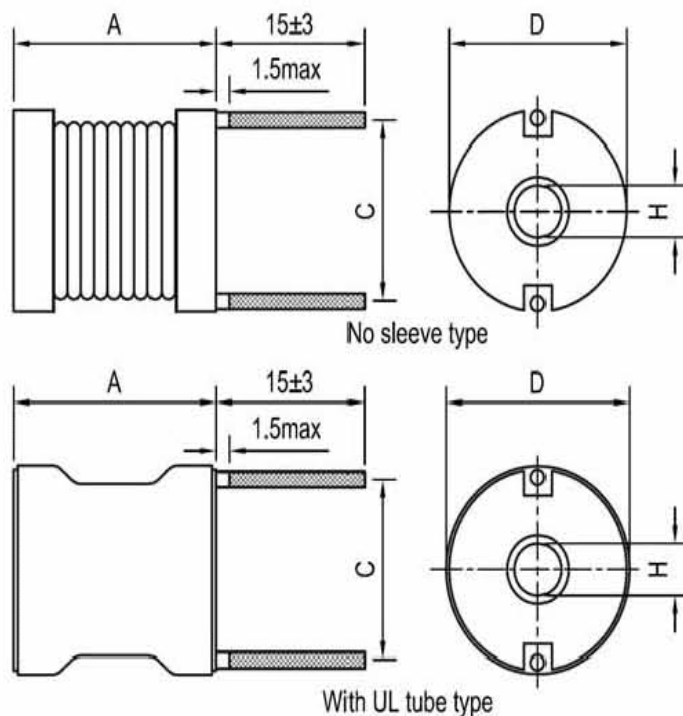

3 L P / N	A max	C typ	D max	H min
DRH1420	21.5	12.0	16.5	3.0
DRH1820	21.5	15.0	21.0	3.0
DRH2620	21.5	22.0	28.0	5.0
DRH3525	28.0	30.0	40.0	3.6



### Features :

- High saturation current .
- Wide range of inductance.
- Ideal for use in switching regulated power supply applications.
- Short height with Self-lead design.
- With center hole for mechanical mounting.
- Varnish coated or UL tube.

### Inductance and rated current ranges :

- DRH1420 1.0uH ~ 560uH 9.0A ~ 0.8A
- DRH1820 1.0uH ~ 2.2mH 11.4A ~ 0.8A
- DRH2620 1.0uH ~ 4.7mH 21.0A ~ 1.0A
- DRH3525 1.8uH ~ 15 mH 27.0A ~ 1.3A

### Test equipments and test setup :

- L : LCR meter @ 1kHz .
- DCR : Milli-ohm meter .
- Electrical specifications at 25 °C .

### Ordering information :

#### DRH 1820 - 100 K - UL

- (1)    (2)    (3) (4) (5)
- (1) Type : Basic model high current choke .
- (2) Style : Core OD=18 mm L=20 mm .
- (3) Inductance : Example : 100 for 10 uH
- (4) Inductance tolerance : K : ±10% ; M: ± 20% .
- (5) Sleeve: "UL": Black UL Tube; No code is no sleeve.

### Characteristics :

- Isat: Obtained when inductance drop by 10% of its nominal value.
- Suggested rated current: copper wire current density about 8.0 A/mm<sup>2</sup> .
- Operating temperature : -20 °C to 80 °C .

### Applications :

- Power supplies and power amplifiers.
- Switching regulators.
- Speaker crossover networks.
- RFI suppression.